

# Soft Absorber

Multiple-Orifice (M12 is Single-Orifice)  
 Fixed Type | Adjustable type | Self-adjusting

## FSB Series (M12、M14、M16)

RoHS Compliant

● Products specification might be changed without notice.



## Characteristics

- High functionality stopper bolt (with an implemented absorber)
- Easy to mount external geometry

## Specifications

Model	Stroke mm	Max. absorption energy J (kgf·m)	Max. equivalent mass kg (kgf)	Range of impact rate m/s	Max. drag N (kgf)	Max. cycle rate cycle/min	Max. absorption energy per minute J/min (kgf·m/min)	Recovering power of the piston rod N (kgf)	Operating temperature °C	Mass g
FSB-1205-C	5	0.68 (0.07)	5 (5)	0.3~1.0	588 (60)	45	65 (6.63)	4.9 or lower (0.5)	-5~70	40
FSB-1407-C	7	2.5 (0.25)	20 (20)		1,078 (110)	60	120 (12.2)	4.9 or lower (0.5)		70
FSB-1609-C	9	6 (0.61)	50 (50)		1,960 (200)	60	200 (20.4)	9.8 or lower (1.0)		115

Material	Main unit	SUM
	Cap	Polyacetal
Surface treatment	Main unit	Nitriding treatment

## Key to Model Number

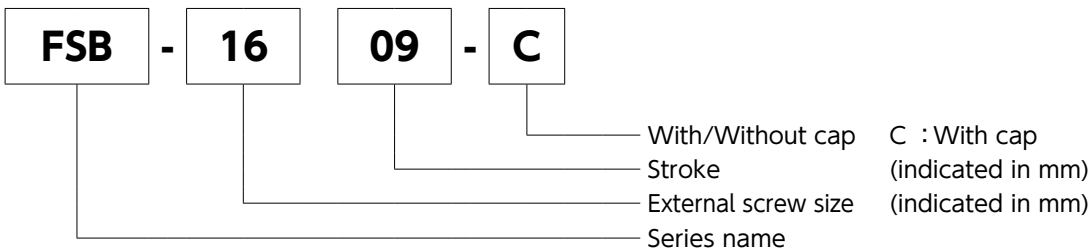

## Dimensions

Model	A	B	C	D	E	F	G	H	J
FSB-1205-C	M12×1.75	5	43	30	8	6	21.9	19	7
FSB-1407-C	M14×2	7	56	40	9	6	25.4	22	8
FSB-1609-C	M16×2	9	74	55	10	8	27.7	24	10

● The thread pitch is different from other absorbers.

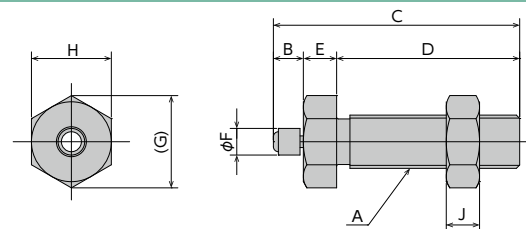

## Precautions for Use

- \* Do not use this product without carefully reading the attached owner's manual.
- \* Ensure that sufficient mounting strength is secured for this product. (As a guideline, it should be 2 to 3 times the maximum drag listed in the catalogue.)
- \* Do not use this product in a vacuum or a location where it may come in contact with oil.
- \* Ensure that an eccentric load is not applied to the soft absorber. (Allowable eccentric angle:  $\pm 2.5^\circ$ )
- \* Do not over-tighten the main unit and nuts. Please use the tightening torque as listed in the owner's manual.
- \* Due to the structure of this product, using the absorber (piston rod side) in an upright position in a dusty environment causes the dust to collect on the absorber, which may affect the durability.

Standard nuts are sold separately as well.

Applicable model	Model
FSB-1205	FSB-1205 nut
FSB-1407	FSB-1407 nut
FSB-1609	FSB-1609 nut