

FEATURE

Quick-replacement contact blocks and transformer units

The snap-on construction makes replacement and addition of contact blocks and transformer units very simple and straightforward.

Oil-and dust-proof operator module construction

The protection level of the AR30/DR30 operator modules conforms to IEC Standard IP65. The special seals protect the operator modules and switch mechanisms against oil, dust, and grime, thus ensuring high performance in dusty and humid environments.

Miniaturization

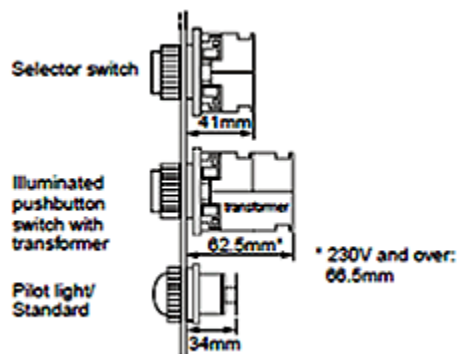

- Selector switches with 1NO+1NC: 41mm deep
Pilot lights: 34mm deep
- The transformer now occupies far less space.

Self-cleaning contacts

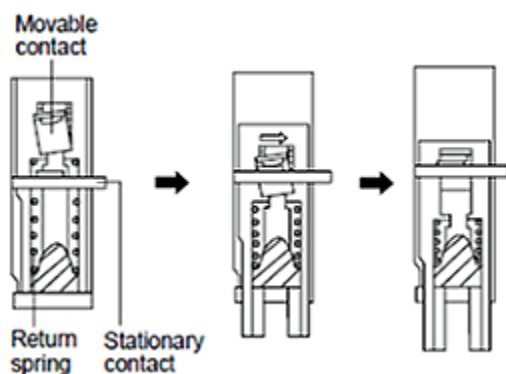

All the contacts are double break type and feature self-cleaning action. Every time the switch is operated, the contact surfaces are wiped with a sliding movement, thus ensuring high contact reliability even at low voltage and small current levels (5V, 5mA).

Metal nut



Safer model with metal nut is also available

Wiring

- Wiring from two directions is possible.
- Wiring in both vertical and lateral directions facilitates wiring in narrow spaces.
- Color coding of contact blocks makes wiring easy.
1NO: Blue, 1NC: Red,
Lamp terminal and transformer unit: Black

Safety

- A terminal cover is provided, assuring safety and security.
- FUJI's original Trigger Action mechanism is used in the emergency stop pushbuttons. They are suitable for emergency stop and safety. This mechanism prevents the contacts from moving until the button is pushed and locked.

Protection

- Excellent oil-tight construction (IP65) of the operator.
- Closure of the contact block has been improved.

DIMENSIONS

Illuminated pushbutton switch Extended AR30E0L, E5L

With transformer

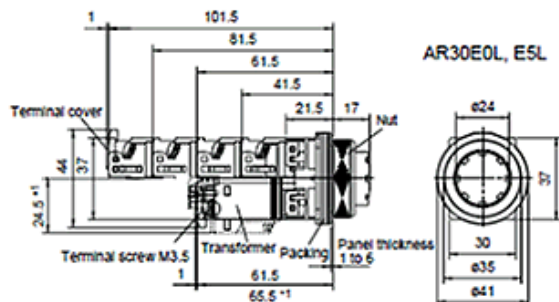

Without transformer

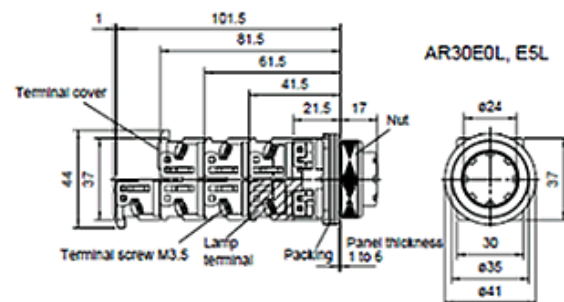

Pushbutton switch Flush/Extended AR30F0R, F5R, FAR, FBR, E0R, E5R, EAR, EBR

Flush/Extended

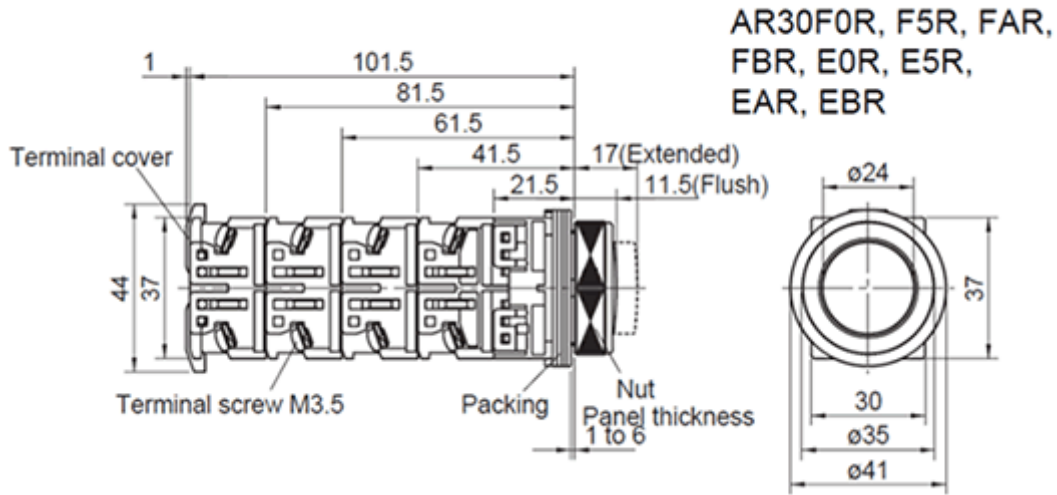

Emergency stop pushbutton switch AR30V0R, V2R

Push-lock, turn-reset (40mm dia.)

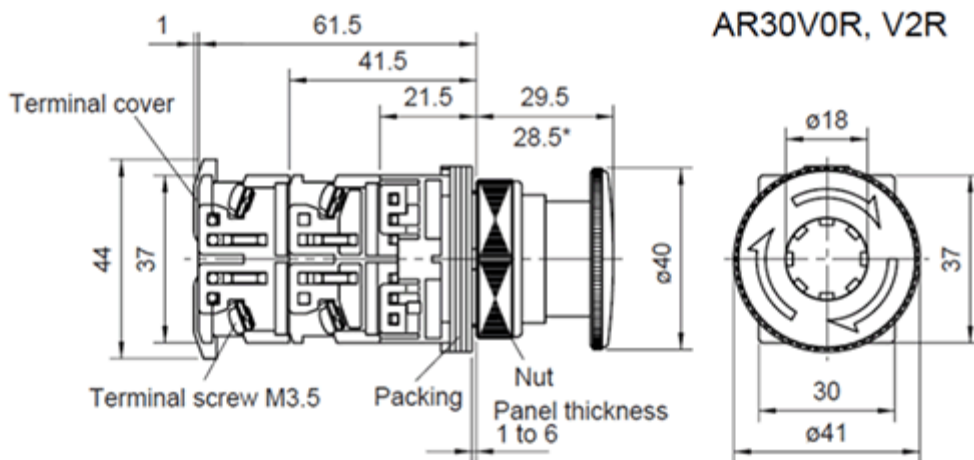

Note: * AR30V2R type

Emergency stop illuminated pushbuttons AR30V0L, V2L

Push-lock, turn-reset (40mm dia.)

With transformer

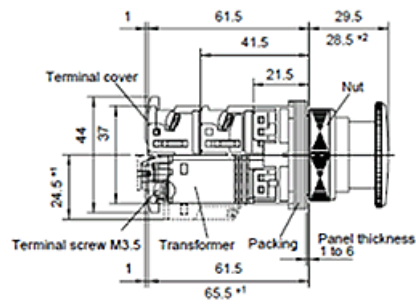

AR30V0L, V2L

Without transformer

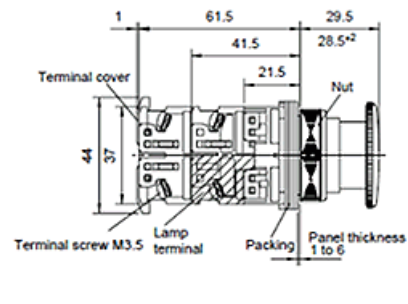

AR30V0L, V2L

Notes: *1 Except for the types 110V AC, 127V AC and 220V AC.
*2 AR30V2L type

Selector switch AR30PR, PCR

Knob

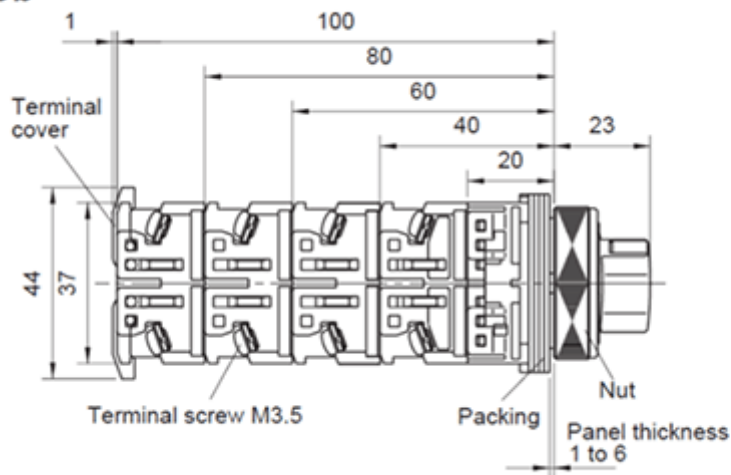

AR30PR, PCR

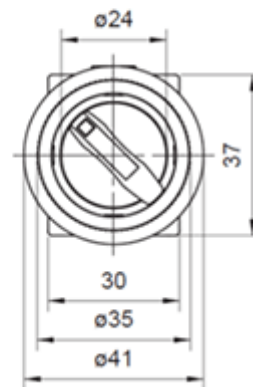

Selector switch with key AR30JR, JCR, JAR

Key

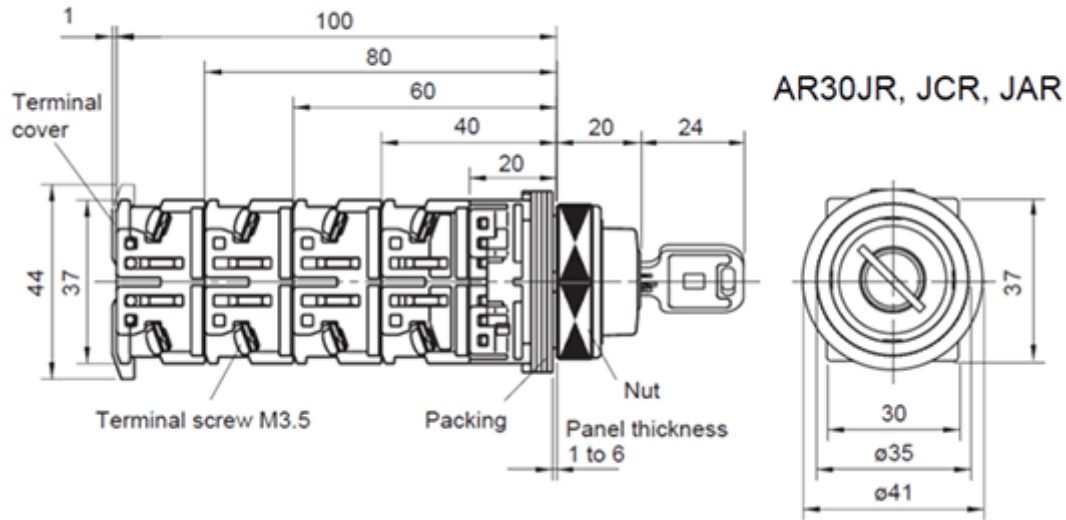

Lever type selector switches AR30HR-2, AR30HR-3, AR30HR-1

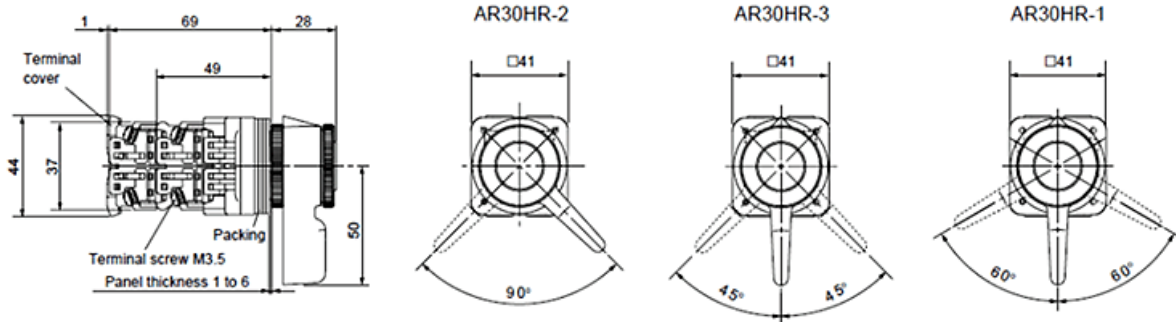

Illuminated selector switch AR30PL

Knob

With transformer

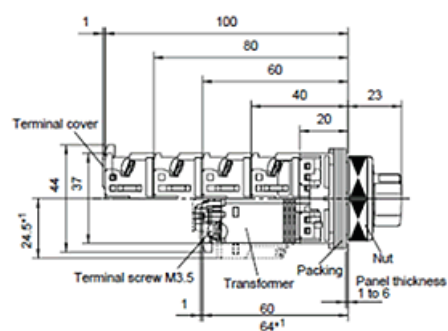

Without transformer

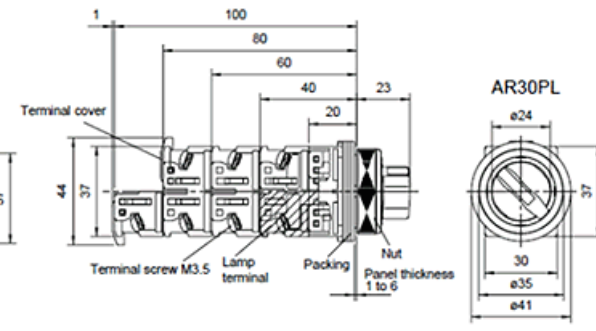

Notes: *1 Except for the types 110V AC, 127V AC and 220V AC.

Pilot lights DR30D0L

Dome

With transformer, with resistor unit

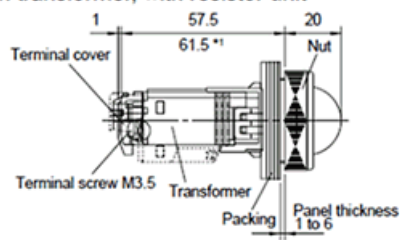

Without transformer

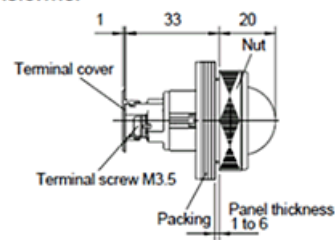

DR30D0L

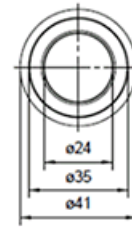

With resistor LED, incandecent (50V DC)

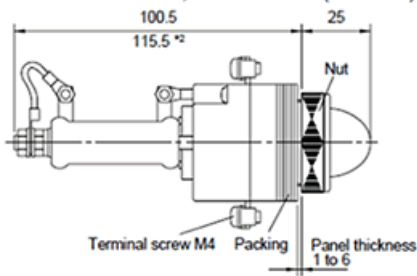

With resistor Incandescent (110, 220V DC)

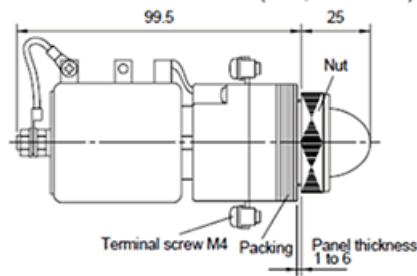

DR30D0L

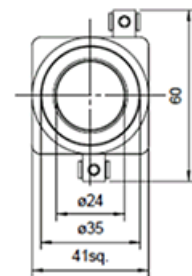

Short-body / with transformer

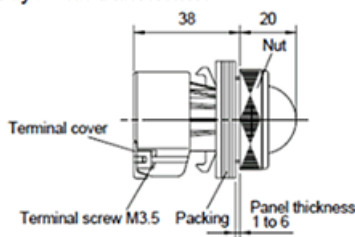

DR30D0L

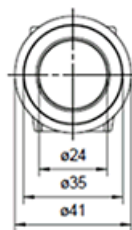

Joy stick selector switches AR30A0N, A5N

Ball type (without lock)

AR30A0N, A5N: Screw terminal

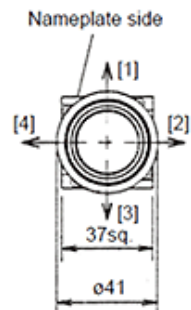
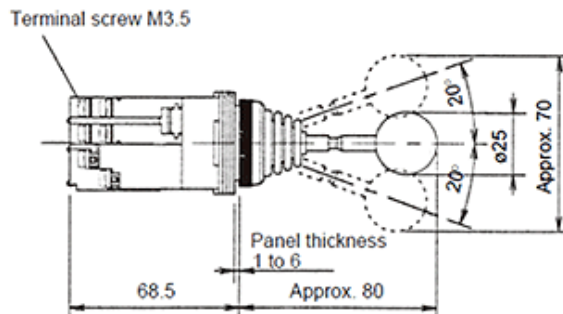
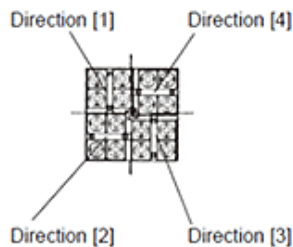

Buzzers DR30B5, B6

Electronic sound

With transformer

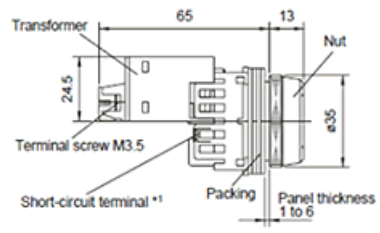

DR30B5, B6

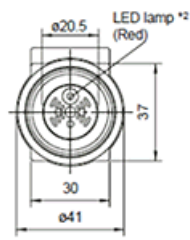

Without transformer

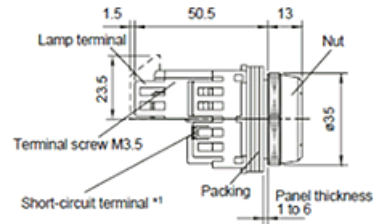

DR30B5, B6

