

SLT

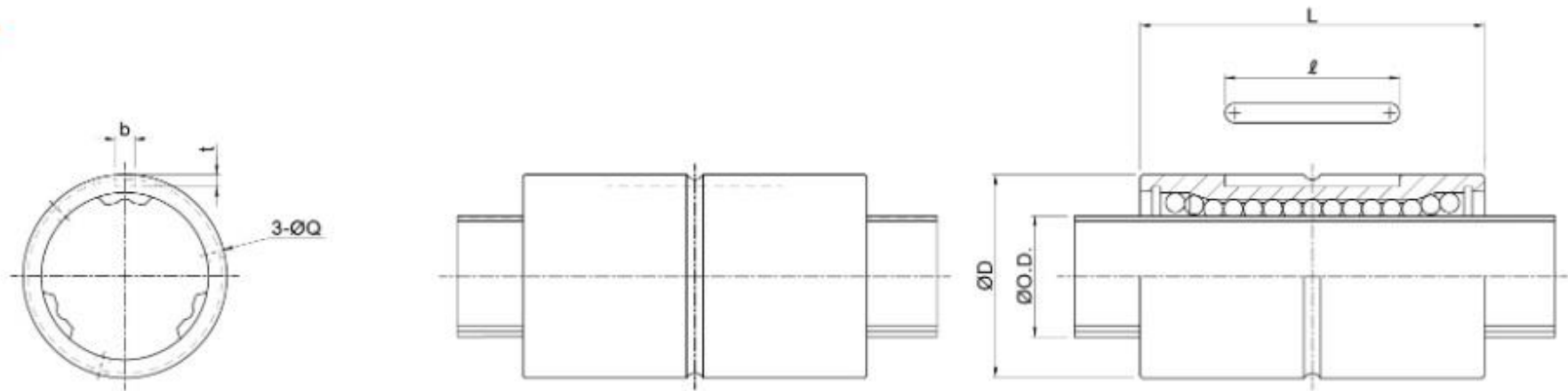

Model No.	Size										Basic torque rating		Basic load rating		Static permissible moment		Mass	
	Diameter		Length		Keyway dimensions			Greasing hole	Shaft diameter	Rows of balls	C_T	C_{OT}	C_a	C_o	M_{A1}	M_{A2}	Nut	Shaft
	D	Tolerance	L	Tolerance	b	t	l	Q	O.D.		(N·m)	(N·m)	(kN)	(kN)	(N·m)	(N·m)	(g)	(kg/m)
16	31	$\begin{matrix} 0 \\ -0.013 \end{matrix}$	50	$\begin{matrix} 0 \\ -0.2 \end{matrix}$	3.5	2	17.5	3	16	3	31.4	34.3	6.9	12.4	60	360	145	1.56
20	35	$\begin{matrix} 0 \\ -0.016 \end{matrix}$	63		4	2.5	29	3	20	3	56.8	55.8	10.1	17.8	120	720	200	2.44
25	42		71	$\begin{matrix} 0 \\ -0.3 \end{matrix}$	4	2.5	36	3	25	3	105	103	15.2	25.3	180	1140	276	3.82